

PNEUMATIC

Characteristic:

- Front and rear caps are finished by aluminum alloy die-casting, CNC mechanically processed with high precision.
- Aluminum tube is imported, stainless forever with friction & corrosion resistance.
- Adopt imported none lubrication, long time service and no need lubrication maintenance.
- Unique cushion technique makes smooth action.
- May add the sensor equipment to easily control.
- In terms of DNC series, pull-rod is hidden inside.



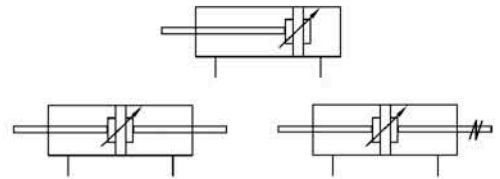

Specification:

| | | | | | | | |
|--------------------------------|---------------------------------|------|------|----|------|-----|-----|
| Type | 32 | 40 | 50 | 63 | 80 | 100 | 125 |
| Motion | Double acting | | | | | | |
| Series | DNC, DNCD | | | | | | |
| Fluid | air | | | | | | |
| Operating pressure range (Mpa) | 0.1~1 | | | | | | |
| Operating speed (mm/sec) | 50~500 | | | | | | |
| Ambient temperature (°C) | -10~70 | | | | | | |
| Cushion | Adjustable cushion at both ends | | | | | | |
| Port size (G) | 1/8" | 1/4" | 3/8" | | 1/2" | | |

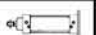
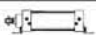
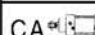
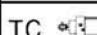

How to order:

| | | | | | | |
|---|--|---|------------|---|--|------------------|
| DNC | 50 | × | 100 | FA | S | 2 |
| Series | Bore | | stroke | Mounting type | with magnet | Sensor |
| DNC Standard Cylinder DNCD Double axial Cylinder | φ 32 φ 40 φ 50 φ 63 φ 80 φ 100 φ 125 | | | Blank(Standard)  FA  CB  FB  LB  CA  TC  | with magnet Switch magnet Blank without magnet | 1:1pcs 2:2pcs |

Stroke:

| bore \ stroke | 25 | 50 | 75 | 100 | 125 | 150 | 175 | 200 | 250 | 300 | 350 | 400 | 450 | 500 | Max.stroke |
|---------------|----|----|----|-----|-----|-----|-----|-----|-----|-----|-----|-----|-----|-----|------------|
| 32 | ● | ● | ● | ● | ● | ● | ● | ● | ● | ● | ● | ● | ● | ● | 1000 |
| 40 | ● | ● | ● | ● | ● | ● | ● | ● | ● | ● | ● | ● | ● | ● | 1200 |
| 50 | ● | ● | ● | ● | ● | ● | ● | ● | ● | ● | ● | ● | ● | ● | 1200 |
| 63 | ● | ● | ● | ● | ● | ● | ● | ● | ● | ● | ● | ● | ● | ● | 1500 |
| 80 | ● | ● | ● | ● | ● | ● | ● | ● | ● | ● | ● | ● | ● | ● | 1500 |
| 100 | ● | ● | ● | ● | ● | ● | ● | ● | ● | ● | ● | ● | ● | ● | 1500 |
| 125 | ● | ● | ● | ● | ● | ● | ● | ● | ● | ● | ● | ● | ● | ● | 1500 |

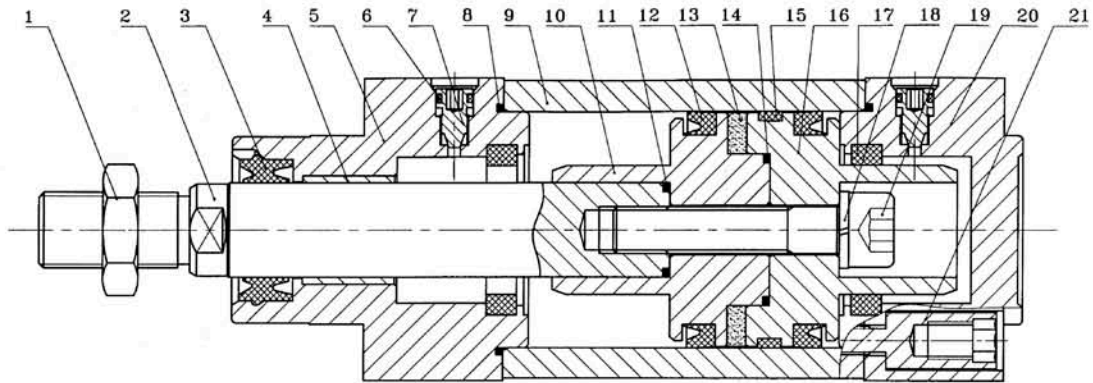

| | | | | | | | |
|---|---------------|----|------------------------|----|---------------|----|--------------------|
| 1 | hexagon nut | 7 | cushion adjusting bolt | 13 | magnet | 19 | inner hexagon bolt |
| 2 | piston ring | 8 | O-ring | 14 | O-ring | 20 | rear cover |
| 3 | compageseal | 9 | tube | 15 | guard seals | 21 | cover nut |
| 4 | oiled bearing | 10 | piston 1 | 16 | piston 2 | | |
| 5 | front cover | 11 | O ring | 17 | compageseal | | |
| 6 | O-ring | 12 | Y seal | 18 | spring washer | | |

DNC Series

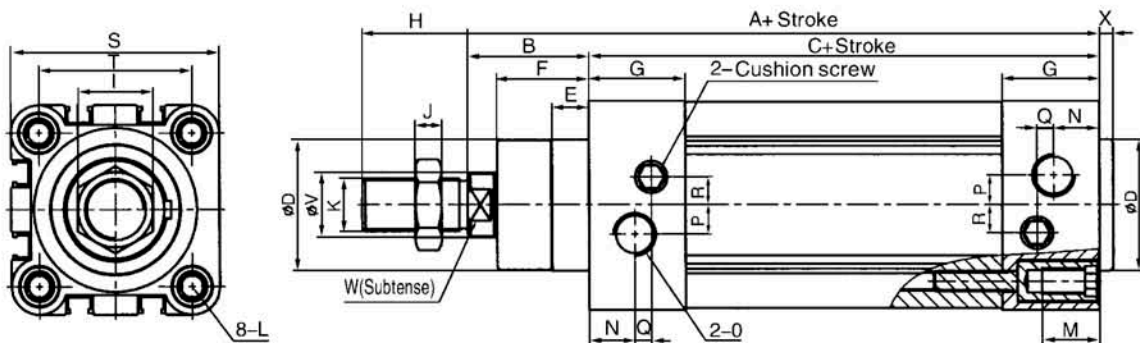

| stroke | A | B | C | D | E | F | G | H | I | J | K | L | M | N | O | P | Q | R | S | T | V | W | X |
|--------|-----|----|-----|----|----|------|------|----|----|----|----------|-----|----|----|------|----|----|----|-----|------|----|----|---|
| 32 | 120 | 26 | 94 | 30 | 10 | 18 | 25 | 22 | 17 | 6 | M10x1.25 | M6 | 16 | 14 | G1/8 | 6 | 3 | 5 | 45 | 32.5 | 12 | 10 | 4 |
| 40 | 135 | 30 | 105 | 35 | 10 | 21.5 | 30 | 24 | 17 | 7 | M12x1.25 | M6 | 16 | 14 | G1/4 | 6 | 3 | 6 | 54 | 38 | 16 | 13 | 4 |
| 50 | 143 | 37 | 105 | 40 | 12 | 28 | 29.5 | 32 | 23 | 8 | M16x1.5 | M8 | 17 | 14 | G1/4 | 9 | 5 | 8 | 65 | 46.5 | 20 | 17 | 4 |
| 63 | 156 | 37 | 121 | 45 | 12 | 28.5 | 35.5 | 32 | 23 | 8 | M16x1.5 | M8 | 17 | 17 | G3/8 | 11 | 6 | 10 | 74 | 56.5 | 20 | 17 | 4 |
| 80 | 174 | 46 | 128 | 45 | 16 | 34.5 | 36 | 40 | 26 | 10 | M20x1.5 | M10 | 17 | 17 | G3/8 | 12 | 10 | 10 | 93 | 72 | 25 | 22 | 4 |
| 100 | 189 | 51 | 138 | 55 | 16 | 38 | 40 | 40 | 26 | 10 | M20x1.5 | M10 | 17 | 19 | G1/2 | 12 | 10 | 10 | 110 | 89 | 25 | 22 | 4 |
| 125 | 225 | 65 | 160 | 60 | 20 | 46 | 45.5 | 54 | 38 | 11 | M27x2 | M12 | 22 | 19 | G1/2 | 13 | 14 | 10 | 135 | 110 | 32 | 27 | 6 |

CA-Single-ear mounting type

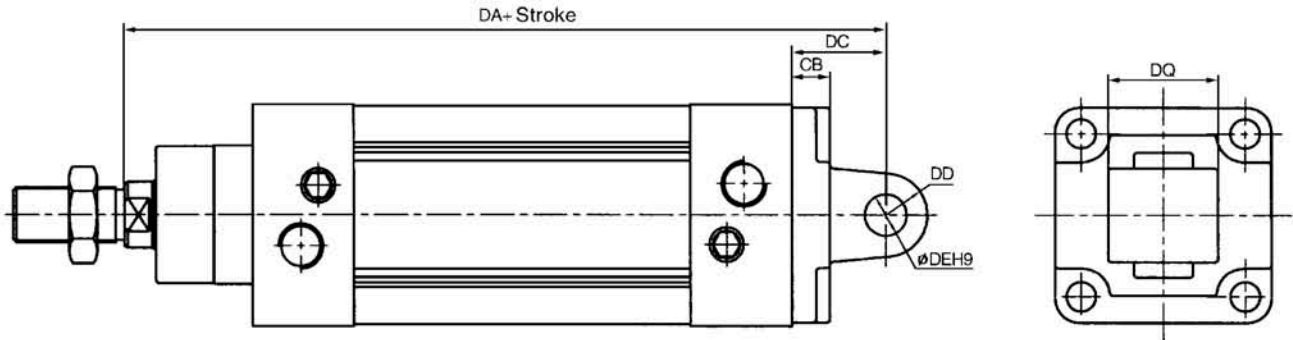

CB-Double-ear mounting type

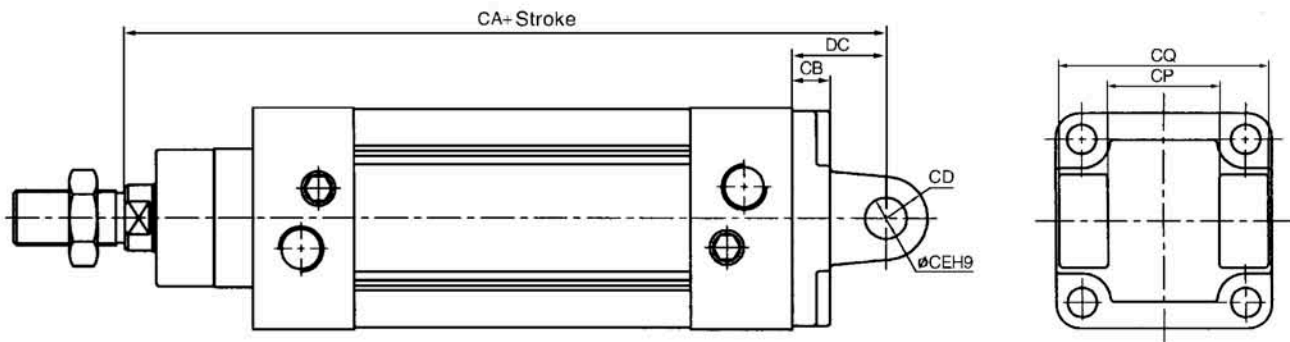

| Bore \ stroke | DA | DC | CB | DD | ø DE | DQ | CA | CC | CB | CD | ø CE | CP | CQ |
|---------------|-----|----|----|----|------|----|-----|----|----|----|------|-----|------|
| 32 | 142 | 22 | 9 | 10 | 10 | 26 | 142 | 22 | 9 | 10 | 10 | 32 | 44.5 |
| 40 | 160 | 25 | 9 | 12 | 12 | 28 | 160 | 25 | 9 | 12 | 12 | 40 | 51.5 |
| 50 | 170 | 27 | 11 | 12 | 12 | 32 | 170 | 27 | 11 | 12 | 12 | 50 | 60 |
| 63 | 190 | 32 | 11 | 16 | 16 | 40 | 190 | 32 | 11 | 16 | 16 | 63 | 70 |
| 80 | 210 | 36 | 14 | 16 | 16 | 50 | 210 | 36 | 14 | 16 | 16 | 80 | 90 |
| 100 | 230 | 41 | 14 | 20 | 20 | 60 | 230 | 41 | 14 | 20 | 20 | 100 | 106 |
| 125 | 270 | 50 | 20 | 30 | 30 | 70 | 275 | 50 | 20 | 30 | 30 | 125 | 130 |

LB-Foot bracket mounting type

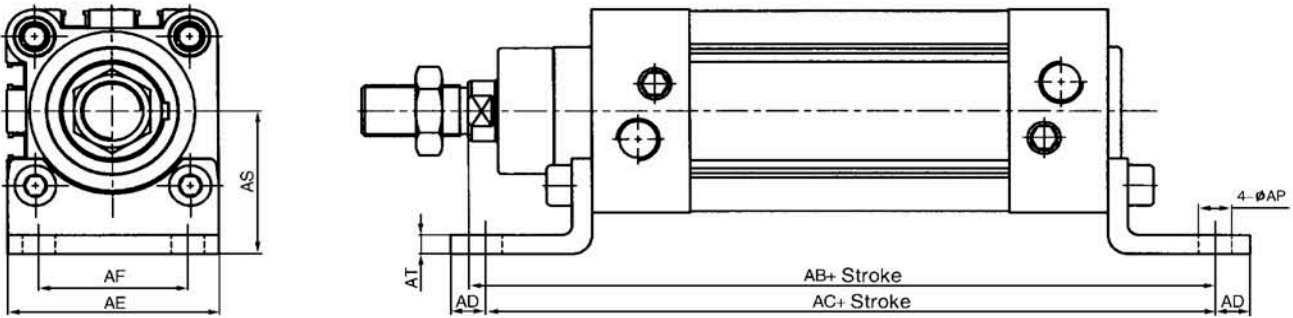

FA, FB-Front&rear flange mounting type

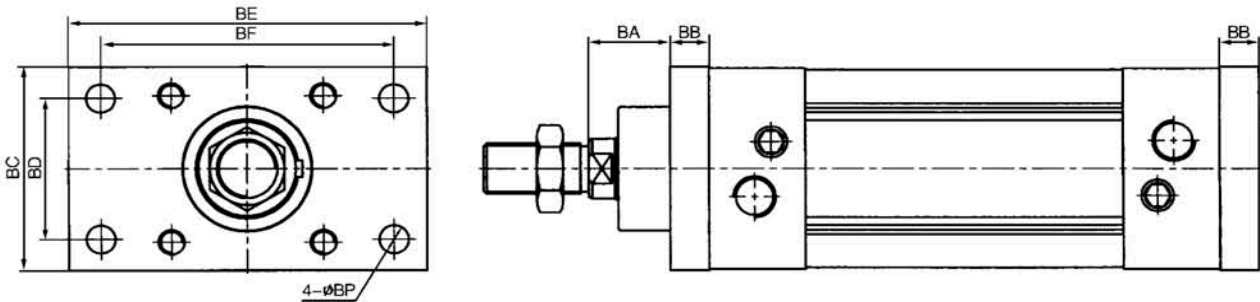

| stroke \ Bore | AB | AC | AD | AE | AF | AP | AS | AT | BA | BB | BC | BD | BE | BF | BP |
|---------------|-----|-----|------|-----|----|------|----|----|----|----|-----|----|-----|-----|----|
| 32 | 144 | 142 | 6.5 | 45 | 32 | 7 | 32 | 5 | 16 | 10 | 50 | 32 | 80 | 64 | 7 |
| 40 | 163 | 161 | 9 | 54 | 36 | 10 | 36 | 5 | 20 | 10 | 55 | 36 | 90 | 72 | 9 |
| 50 | 175 | 170 | 10.5 | 64 | 45 | 10 | 45 | 6 | 25 | 12 | 65 | 45 | 110 | 90 | 9 |
| 63 | 190 | 185 | 12.5 | 75 | 50 | 10 | 50 | 6 | 25 | 12 | 75 | 50 | 125 | 100 | 9 |
| 80 | 215 | 210 | 15 | 93 | 63 | 12 | 63 | 6 | 30 | 16 | 100 | 63 | 154 | 126 | 12 |
| 100 | 230 | 220 | 17.5 | 110 | 75 | 14.5 | 71 | 6 | 35 | 16 | 120 | 75 | 186 | 150 | 14 |
| 125 | 270 | 250 | 22 | 131 | 90 | 16.5 | 90 | 8 | 45 | 20 | 150 | 90 | 220 | 180 | 16 |